

MWPS-72056

36' Pole Utility Building

CAUTION!

Additional professional services will be required to tailor this plan to your situation, including but not limited to: assurance of compliance with codes and regulations; review of specifications for materials and equipment; supervision of site selection, bid letting and construction; and provision for utilities, waste management, roads or other access. **Furthermore, any deviation from the given specifications may result in structural failure, property damage, and personal injury including loss of life.**

WARRANTY DISCLAIMER

This plan provides conceptual information only. **Neither midwest plan service nor any of the cooperating land-grant universities, or their respective agents or employees, have made, and do not hereby make, any representation, warranty or covenant with respect to the specifications in this plan.** Additional professional services will be required to tailor this plan to your situation, including but not limited to: assurance of compliance with codes and regulations; review of specifications for materials and equipment; supervision of site selection, bid letting and construction; and provision for utilities, waste management, roads or other access.

MIDWEST PLAN SERVICE
Cooperative Extension Work in Agriculture and Home Economics and Agricultural Experiment Stations of North Central Region - USDA Cooperating
36' Pole Utility Building
Title Page
MIDWEST PLAN NO. 72056

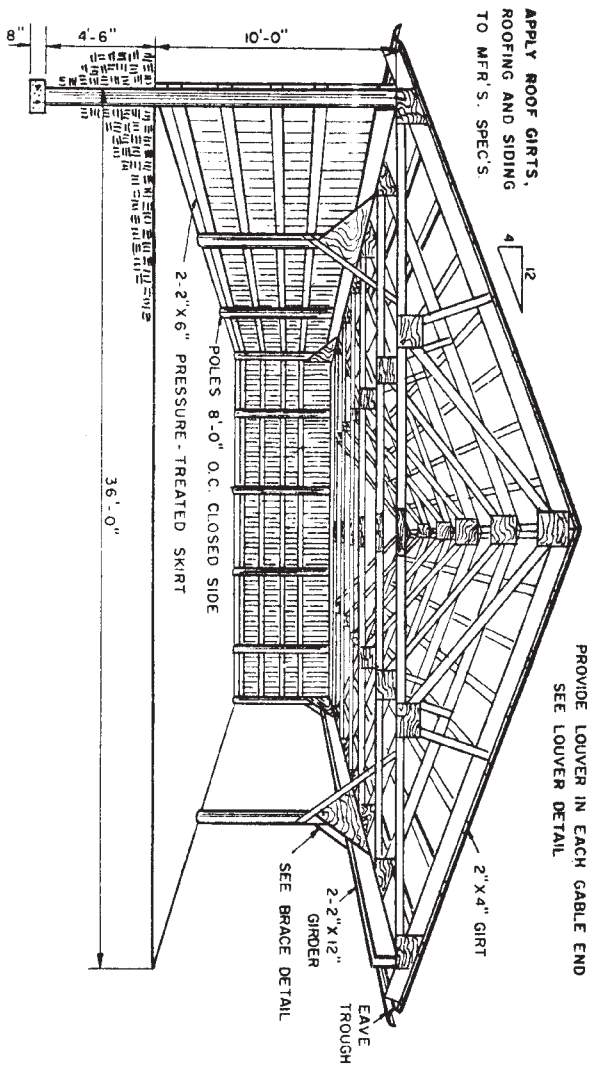

PROVIDE LOUVER IN EACH GABLE END
SEE LOUVER DETAIL

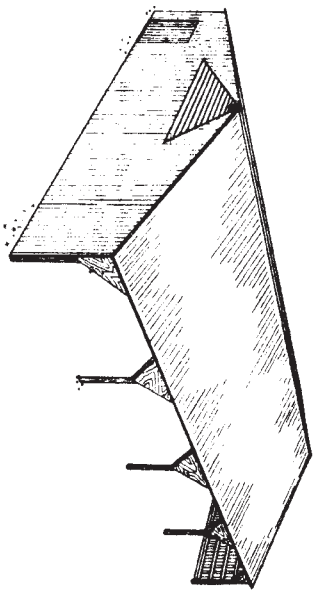

WITH ONE SIDE OPEN, THE BUILDING CAN BE USED FOR:
Beef housing and/or feeding.
Dairy resting barn.
Machinery housing.

WITH ALL SIDES CLOSED, THE BUILDING CAN BE USED FOR:
Insulated:
Livestock housing.
Poultry housing.
Uninsulated:
Rural warehousing.
Machinery housing.

All lumber in contact with manure or the soil should be pressure-treated with an oil-base preservative.

POLE SIZES: 5" top x 16', 16'-0" O.C.
In front and back walls,
4" top x 12', intermediate
poles in ends and back wall

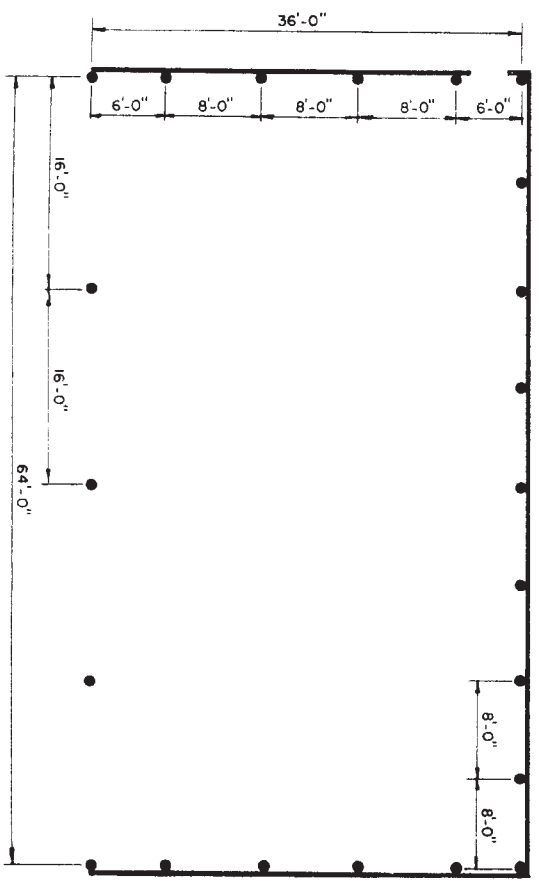

Sheet 4: 36' Span Trusses

MIDWEST PLAN SERVICE
Cooperative Extension Work in Agriculture, Home Economics, and Agricultural Experiment Stations of North Central Region - USDA Cooperating
36' POLE UTILITY BUILDING
Sheet 1 of 4 Sheets
MIDWEST PLAN NO. 72056

Copyright © 1964 Midwest Plan Service

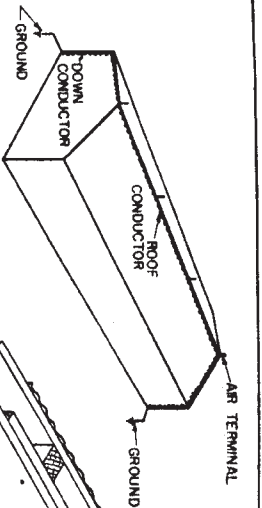

LIGHTNING PROTECTION FOR CABLE ROOFS

Air Terminals
At least 24" long.
Up to 25' apart.
1/2" copper or 5/8" aluminum.
5/8" copper tubing, wall thickness over 0.032"

Conductors 17 AWG wire, 181M/1000'.
Aluminum: 14 AWG wire, 95M/1000'.
Two down conductors, minimum, on opposite corners.
For bldgs. over 110' long, use one down conductor per 50' add'l length.

Grounds
One ground per down conductor.
Rods buried at least 10'.
If water pipe enters bldg, bond at least one down conductor to it.

Metal Roofs
Ground metal roofs without air terminals by attaching 18" of conductors to roofing with 2-3/8" J or U bolts. Ground down conductors as with air terminals.

Master Label
For maximum lightning protection obtain a Master Label System as approved by the Underwriters' Laboratories, Inc.

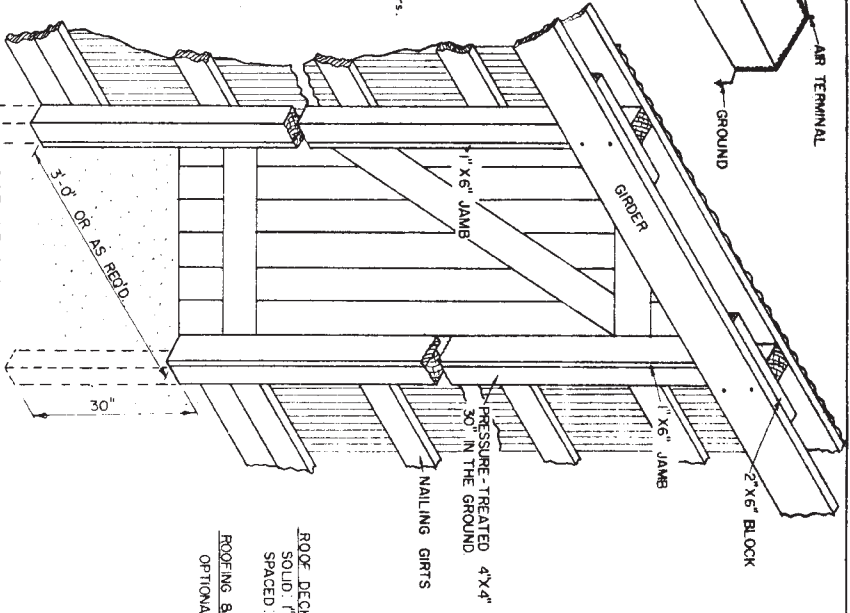

ROOF DECK
SOLID T & G LUMBER OR EQUIVALENT
SPACED: 2' X 4" GIRTS, LAD FLAT, FOLLOW ROOFING MFR'S SPECS.
OPTIONAL: APPLY TO MFR'S SPECS.

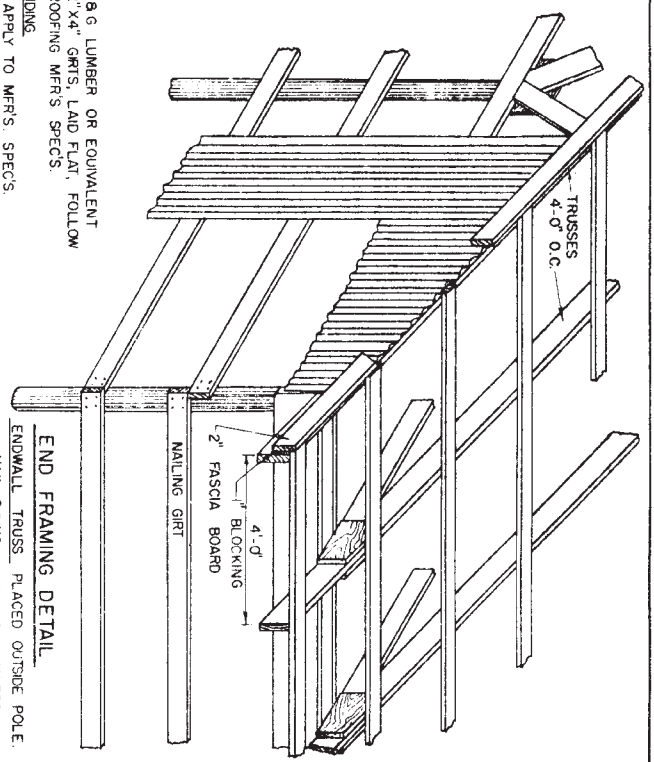

END FRAMING DETAIL
ENDWALL TRUSS PLACED OUTSIDE POLE.
NAIL SIDING TO TRUSS MEMBERS

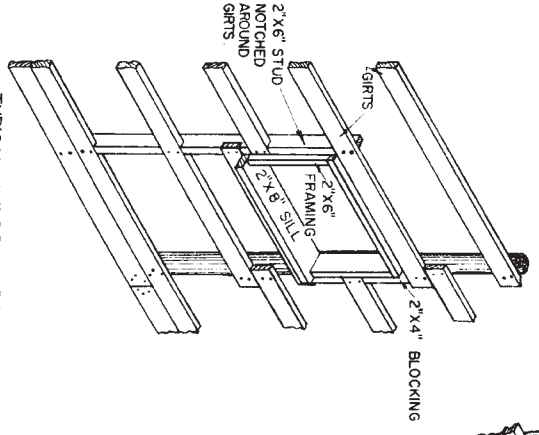

TYPICAL WINDOW FRAMING
SELECT STOPS & HARDWARE TO SUIT TYPE OF SASH USED

DOOR FRAMING DETAIL
USE SIMILAR FRAMING FOR LARGE DOOR IN ENDWALL

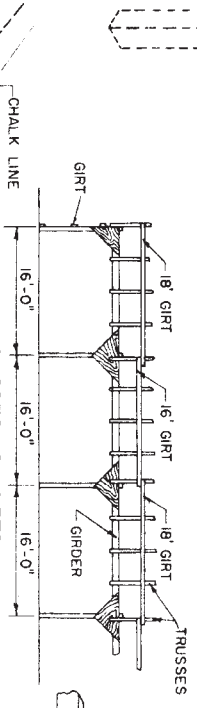

TRUSSES & GIRTS

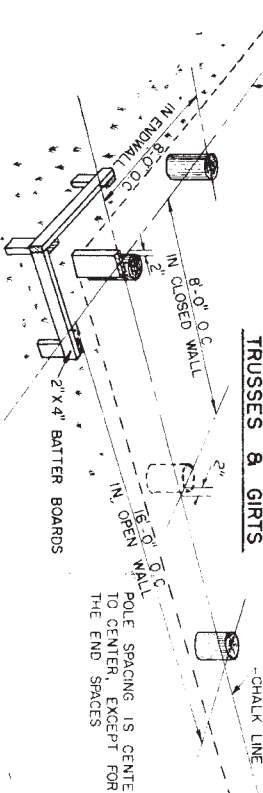

TYPICAL LOUVER CONSTRUCTION

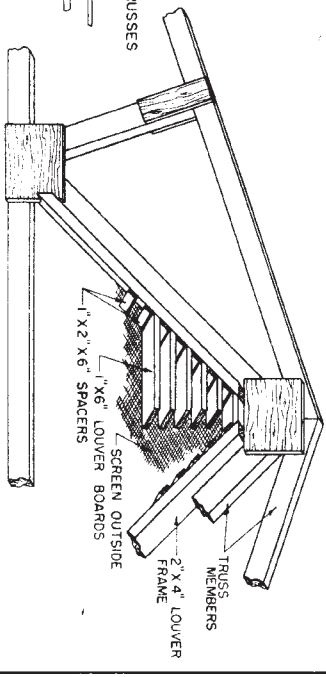

SHEET 3 - 24' SPAN TRUSSES	
MIDWEST PLAN SERVICE	
COOPERATIVE EXTENSION WORK IN AGRICULTURE AND HOME ECONOMICS OF NORTH CENTRAL REGION, USDA COOPERATING	
24' POLE	
UTILITY BUILDING	
6011	SHEET 2 OF 3 SHEETS
MIDWEST PLAN NO. 72054	

BUILDING SECTION (16' LONG)

ITEM	DESCRIPTION	BEGINNING NO. FBM	ADDITIONAL NO. FBM	CLOSING NO. FBM
Concrete Poles	Cu. feet	4	2	2
	5' Top x 16'	4	2	2
	4' Top x 16'	3	1	3
Girders	2"x8"x16'0"	4	85 1/3	4
Bracing-	2"x4"x8' c-c, Ext. Plywood	1 1/2	1	85 1/3
	2"x4"x14'0"	3	28	1
	2"x6"x6'0"	2	12	1
	2"x6"x7'0"	2	14	6
Trusses	See Page 3	5	3	4
Girts	2"x4"x16'0"	7	74 2/3	7
	2"x4"x18'0"	7	84	7
	2"x6"x16'0"	10	160	10
Skirt Siding	2"x6"x16'0" Pressure-treated	5	80	5
Roofing	Sq. feet	445	160	445
	Sq. feet *	448	448	448
Louwer	Ln. feet Eaves trough	32	32	32
	2"x4"x6'0"	2	2	8
	1"x6"x10'0"	5	25	5
	1"x2"x12'0"	1	2	1
Man door	Sq. ft. screen	15	34	15
	4"x4"x12'6"	2	2	2
	2"x6"x2'0"	1	2	1
	1"x6"x10'0"	11	55	15

